

In-Line Ball Check Valve – General Specification

The information on this document is strictly confidential and may not be reproduced in any way without prior written permission of Argus
PRINTED COPIES ARE UNCONTROLLED

1.0 PURPOSE

To outline the general specifications of an Argus Check Valve.

2.0 CHECK VALVE

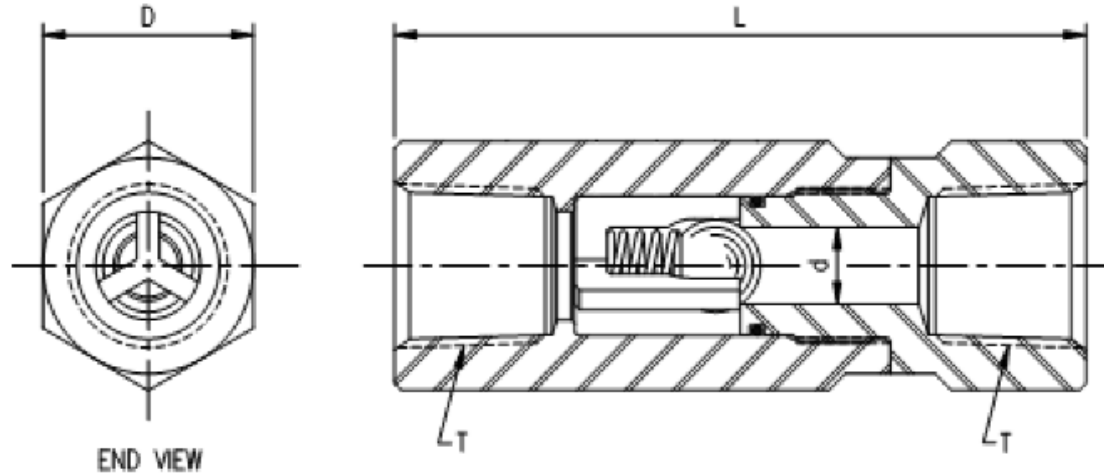

Figure 1.0: Argus Check Valve

Specifications are Subject to Change Without Prior Notice – All Dimensions: inch [mm]

Created By:	Jason Weiss
Created Date:	01 Jan 2003
Approved By:	
Approved Date:	
ECN No.:	02690
Page:	1 of 3

In-Line Ball Check Valve – General Specification

The information on this document is strictly confidential and may not be reproduced in any way without prior written permission of Argus
PRINTED COPIES ARE UNCONTROLLED

Table 1.0: General Specification

NOM. SIZE	ARGUS MODEL No.	ASSEMBLY DWG. No.	'T' END CONNECTION	MAWP (psi)	DIMENSIONS				MATERIAL GRADE	WEIGHT (lbs)
					'D' O.D.		'd' I.D.	'L'		
					HEXAGON	ROUND	ORIFICE	O/A LG.		
1/4"	FFBDL-025	CVA-025-000	1/4" FNPT	3000	1"	-----	1/4"	3 1/8"	AISI 1018/8620 Steel	0.3
	FFBFL-025	CVE-025-000	1/4" FNPT	6000	1 1/8"	-----	1/4"	3 5/8"	AISI 1018/8620 Steel	1.0
	FFBEL-025	CVB-025-000	1/4" FNPT	10,000	1 3/8"	-----	1/4"	3 7/8"	AISI 1018/8620 Steel	1.6
	FFBDS-025	CVC-025-000	1/4" FNPT	3000	1"	-----	1/4"	3 1/8"	AISI 316 Stainless Steel	0.3
	FFBFS-025	CVF-025-000	1/4" FNPT	6000	1 1/8"	-----	1/4"	3 5/8"	AISI 316 Stainless Steel	1.0
	FFBES-025	CVD-025-000	1/4" FNPT	10,000	1 3/8"	-----	1/4"	3 7/8"	AISI 316 Stainless Steel	1.6
3/8"	FFBDL-037	CVA-037-000	3/8" FNPT	3000	1 1/8"	-----	3/8"	4 1/2"	AISI 1018/8620 Steel	0.3
	FFBFL-037	CVE-037-000	3/8" FNPT	6000	1 3/8"	-----	3/8"	4 7/8"	AISI 1018/8620 Steel	1.9
	FFBEL-037	CVB-037-000	3/8" FNPT	10,000	1 3/4"	-----	3/8"	5 1/8"	AISI 1018/8620 Steel	3.4
	FFBDS-037	CVC-037-000	3/8" FNPT	3000	1 1/8"	-----	3/8"	4 1/2"	AISI 316 Stainless Steel	1.1
	FFBFS-037	CVF-037-000	3/8" FNPT	6000	1 3/8"	-----	3/8"	4 7/8"	AISI 316 Stainless Steel	2.0
	FFBES-037	CVD-037-000	3/8" FNPT	10,000	1 3/4"	-----	3/8"	5 1/8"	AISI 316 Stainless Steel	3.4
1/2"	FFBDL-050	CVA-050-000	1/2" FNPT	3000	1 1/4"	-----	3/8"	4 1/2"	AISI 1018/8620 Steel	1.3
	FFBFL-050	CVE-050-000	1/2" FNPT	6000	1 3/8"	-----	3/8"	4 7/8"	AISI 1018/8620 Steel	1.8
	FFBEL-050	CVB-050-000	1/2" FNPT	10,000	1 3/4"	-----	3/8"	5 1/8"	AISI 1018/8620 Steel	3.3
	FFBDS-050	CVC-050-000	1/2" FNPT	3000	1 1/4"	-----	3/8"	4 1/2"	AISI 316 Stainless Steel	1.3
	FFBFS-050	CVF-050-000	1/2" FNPT	6000	1 3/8"	-----	3/8"	4 7/8"	AISI 316 Stainless Steel	1.9
	FFBES-050	CVD-050-000	1/2" FNPT	10,000	1 3/4"	-----	3/8"	5 1/8"	AISI 316 Stainless Steel	3.3
3/4"	FFBDL-075	CVA-075-000	3/4" FNPT	3000	1 1/2"	-----	1/2"	5"	AISI 1018/8620 Steel	2.0
	FFBFL-075	CVE-075-000	3/4" FNPT	6000	1 3/4"	-----	1/2"	5 1/4"	AISI 1018/8620 Steel	3.1
	FFBEL-075	CVB-075-000	3/4" FNPT	10,000	2 1/2"	-----	1/2"	5 3/4"	AISI 1018/8620 Steel	7.9
	FFBDS-075	CVC-075-000	3/4" FNPT	3000	1 1/2"	-----	1/2"	5"	AISI 316 Stainless Steel	2.1
	FFBFS-075	CVF-075-000	3/4" FNPT	6000	1 3/4"	-----	1/2"	5 1/4"	AISI 316 Stainless Steel	3.2
	FFBES-075	CVD-075-000	3/4" FNPT	10,000	2 1/2"	-----	1/2"	5 3/4"	AISI 316 Stainless Steel	7.9
1"	FFBDL-100	CVA-100-000	1" FNPT	3000	1 7/8"	-----	5/8"	5 3/4"	AISI 1018/8620 Steel	3.6
	FFBFL-100	CVE-100-000	1" FNPT	6000	2"	-----	5/8"	6 1/8"	AISI 1018/8620 Steel	4.5
	FFBEL-100	CVB-100-000	1" FNPT	10,000	3 1/4"	-----	5/8"	6 7/8"	AISI 1018/8620 Steel	16.0
	FFBDS-100	CVC-100-000	1" FNPT	3000	1 7/8"	-----	5/8"	5 3/4"	AISI 316 Stainless Steel	3.7
	FFBFS-100	CVF-100-000	1" FNPT	6000	2"	-----	5/8"	6 1/8"	AISI 316 Stainless Steel	4.7
	FFBES-100	CVD-100-000	1" FNPT	10,000	-----	3 1/4"	5/8"	6 7/8"	AISI 316 Stainless Steel	14.5
1 1/4"	FFBDL-125	CVA-125-000	1 1/4" FNPT	3000	2 1/2"	-----	1"	8"	AISI 1018/8620 Steel	8.6
	FFBFL-125	CVE-125-000	1 1/4" FNPT	6000	2 3/4"	-----	1"	8 1/8"	AISI 1018/8620 Steel	11.3
	FFBEL-125	CVB-125-000	1 1/4" FNPT	10,000	-----	3 3/8"	1"	8 1/2"	AISI 1018/8620 Steel	17.7
	FFBDS-125	CVC-125-000	1 1/4" FNPT	3000	2 1/2"	-----	1"	8"	AISI 316 Stainless Steel	8.9
	FFBFS-125	CVF-125-000	1 1/4" FNPT	6000	2 3/4"	-----	1"	8 1/8"	AISI 316 Stainless Steel	11.5
	FFBES-125	CVD-125-000	1 1/4" FNPT	10,000	-----	3 1/2"	1"	8 1/2"	AISI 316 Stainless Steel	19.3

In-Line Ball Check Valve – General Specification

The information on this document is strictly confidential and may not be reproduced in any way without prior written permission of Argus
PRINTED COPIES ARE UNCONTROLLED

1 1/2"	FFBDL-150	CVA-150-000	1 1/2" L.P. BOX	3000	2 1/2"	-----	1"	8"	AISI 1018/8620 Steel	8.0
	FFBFL-150	CVE-150-000	1 1/2" L.P. BOX	6000	2 3/4"	-----	1"	8 1/8"	AISI 1018/8620 Steel	10.7
	FFBEL-150	CVB-150-000	1 1/2" L.P. BOX	10,000	-----	3 3/8"	1"	8 1/2"	AISI 1018/8620 Steel	16.9
	FFBDS-150	CVC-150-000	1 1/2" L.P. BOX	3000	2 1/2"	-----	1"	8"	AISI 316 Stainless Steel	8.3
	FFBFS-150	CVF-150-000	1 1/2" L.P. BOX	6000	2 3/4"	-----	1"	8 1/8"	AISI 316 Stainless Steel	11.1
	FFBES-150	CVD-150-000	1 1/2" L.P. BOX	10,000	-----	3 1/2"	1"	8 1/2"	AISI 316 Stainless Steel	18.6
2"	FFBDL-200	CVA-200-000	2" L.P. BOX	3000	3 1/4"	-----	1 1/4"	8 1/2"	AISI 1018/8620 Steel	14.9
	FFBFL-200	CVE-200-000	2" L.P. BOX	6000	3 1/2"	-----	1 1/4"	8 3/4"	AISI 1018/8620 Steel	18.9
	FFBEL-200	CVB-200-000	2" L.P. BOX	10,000	-----	3 7/8"	1 1/4"	9 1/2"	AISI 1018/8620 Steel	24.1
	FFBDS-200	CVC-200-000	2" L.P. BOX	3000	-----	3 1/4"	1 1/4"	8 1/2"	AISI 316 Stainless Steel	13.6
	FFBFS-200	CVF-200-000	2" L.P. BOX	6000	-----	3 1/2"	1 1/4"	8 3/4"	AISI 316 Stainless Steel	17.2
	FFBES-200	CVD-200-000	2" L.P. BOX	10,000	-----	4"	1 1/4"	9 1/2"	AISI 316 Stainless Steel	26.4